

Assembly Instruction	
----------------------	--

CF 9370
(5' QUEEN)

Step 1



x16



x8

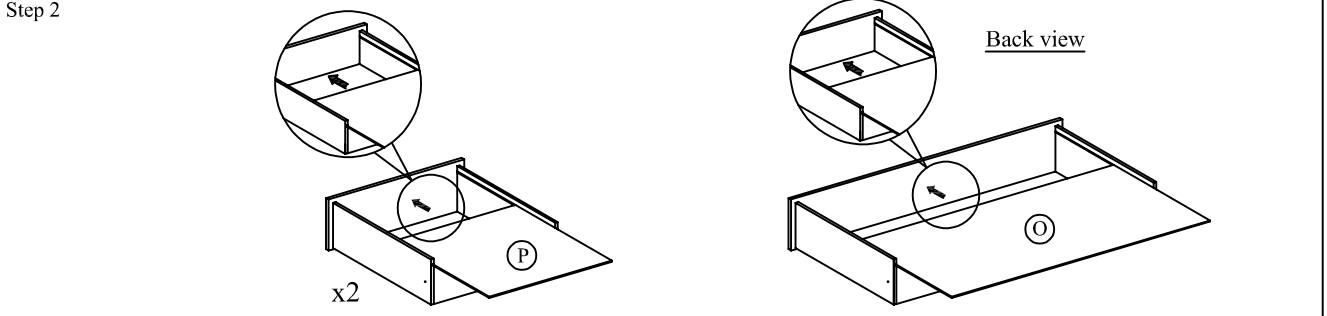
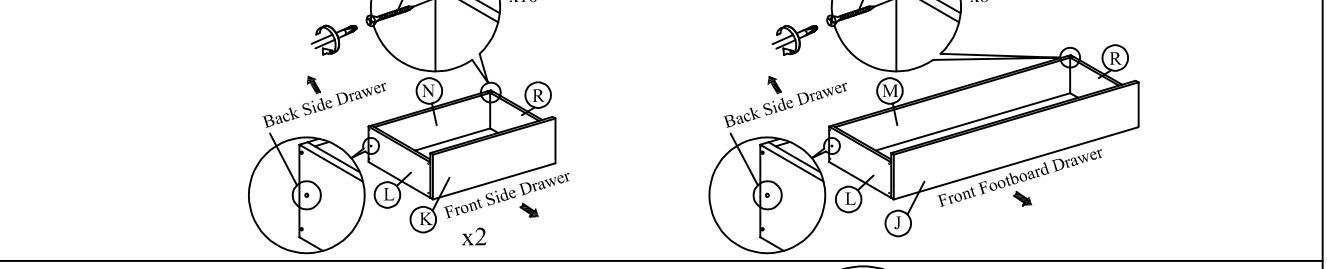

Step 2



Back view

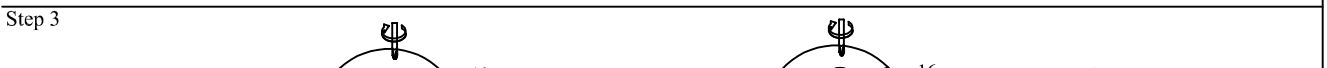
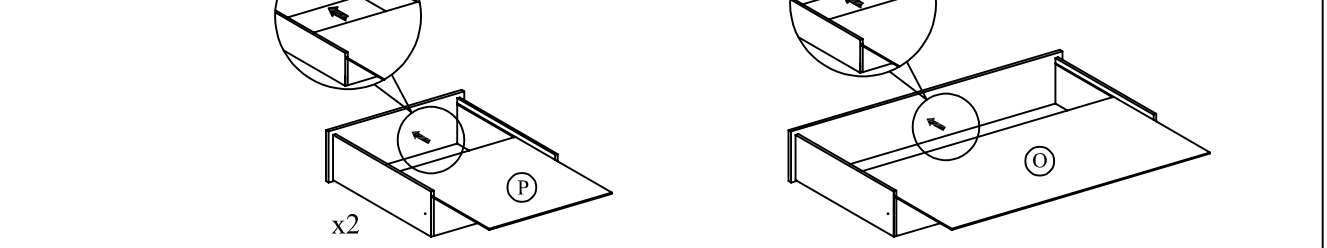

$$\text{Step 3} \quad \begin{array}{c} \text{②} \\ \text{③} \end{array} \quad \begin{array}{c} \text{②} \\ \text{③} \end{array}$$

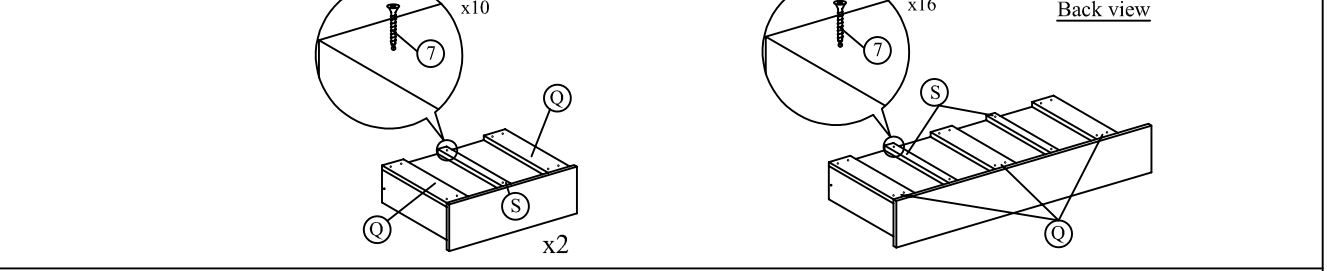

Marking at the Wooden !

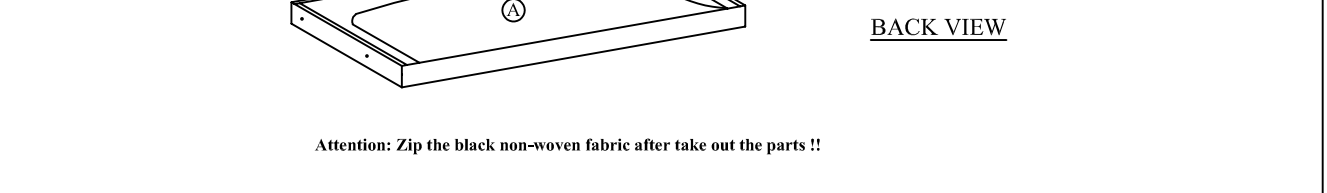
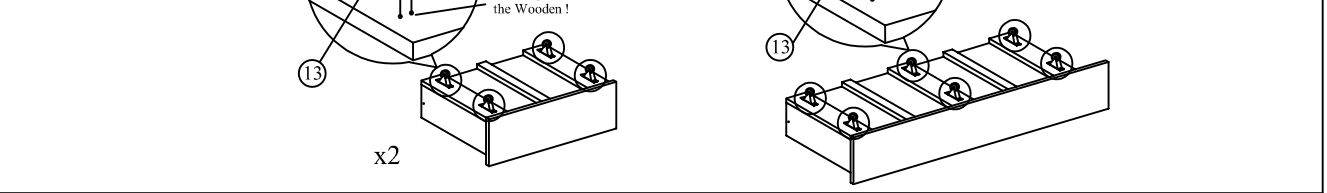

HARDWARE		

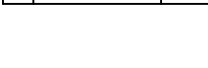
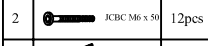

Assembly Instruction

Step 6

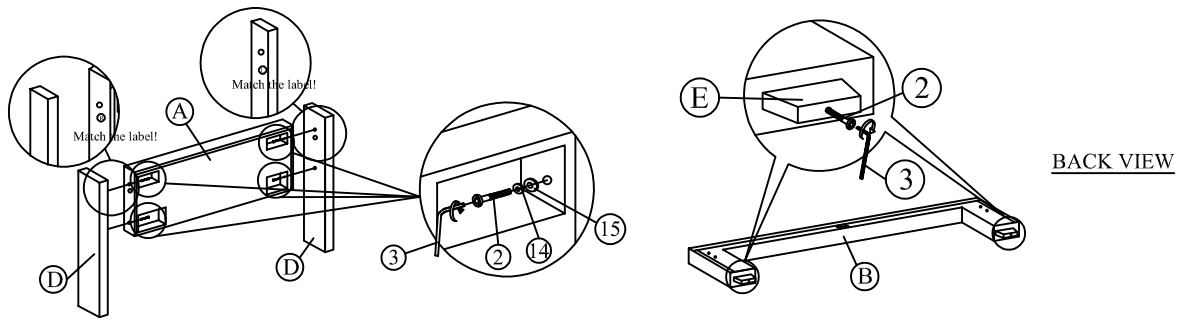

Step 7

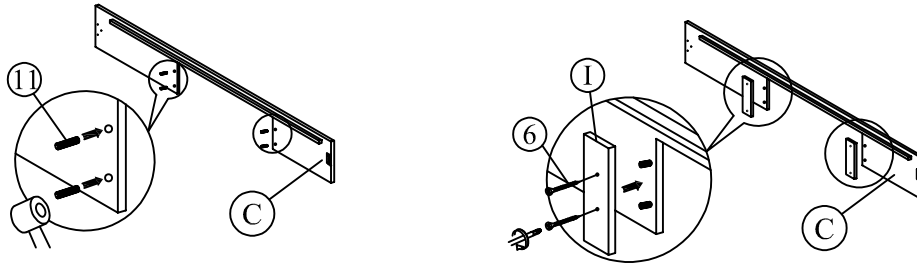

Step 8

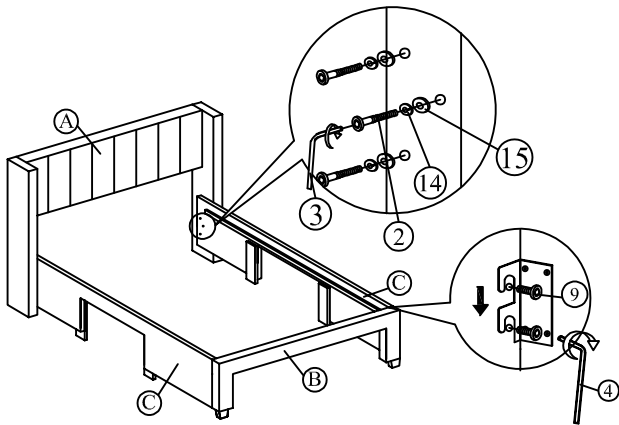

Step 9

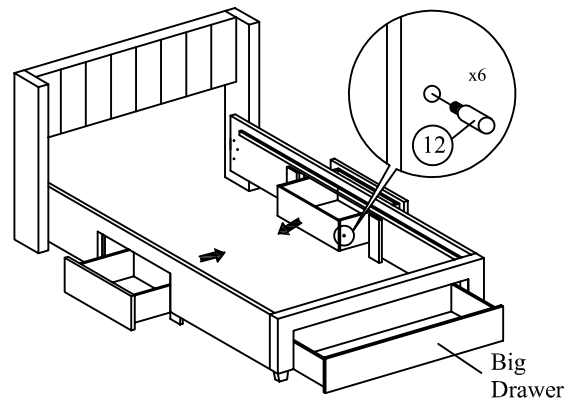

Step 10

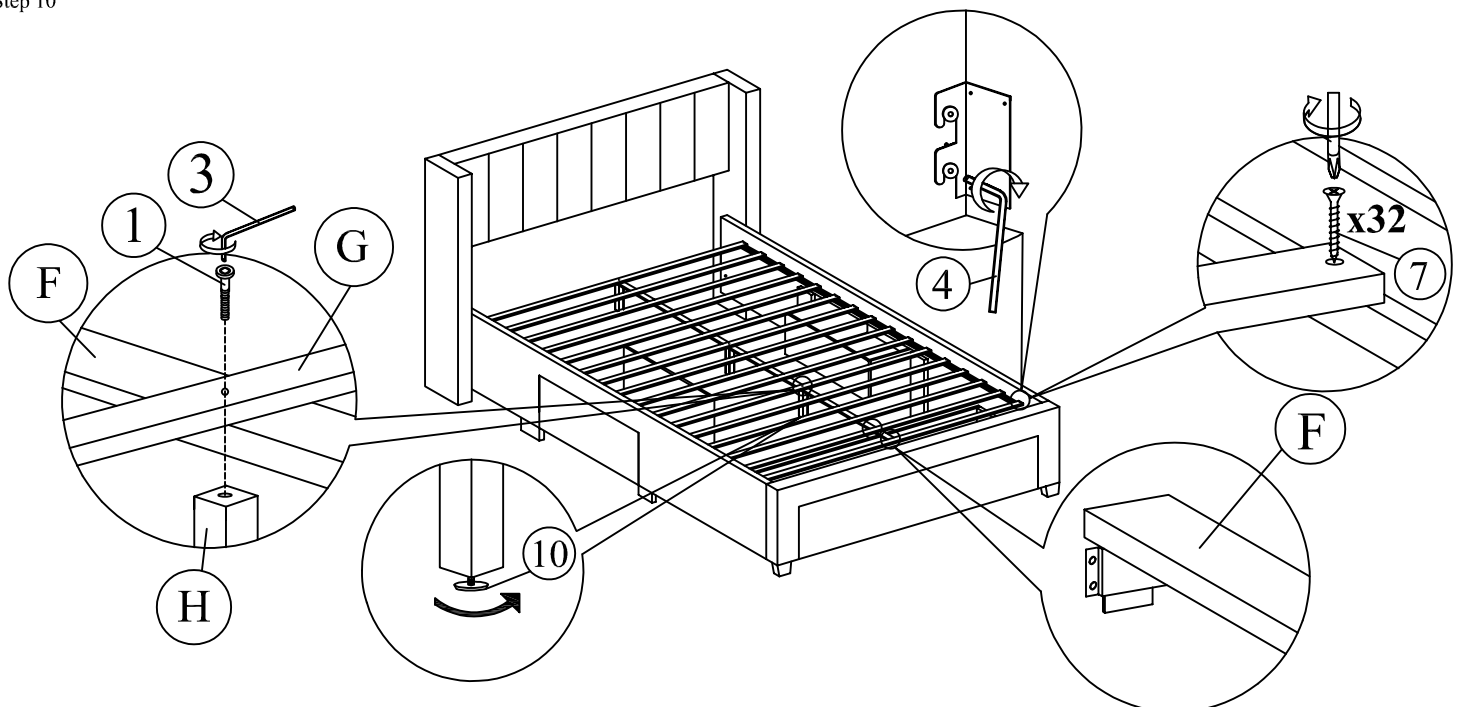

Important Information

Please note that the recommended process for adjusting centre legs when assembling your bed.

Before placing the mattress on the base, please ensure that the **SUPPORT LEGS ARE NOT QUITE TOUCHING THE FLOOR**. When the bed is then in use the support legs will sit firmly on the solid surface.

PLEASE ENSURE THAT THE LEGS ARE VERTICAL.

DUE TO THE NATURE OF LAMINATE / WOODEN FLOORING WE RECOMMEND THAT YOU PLACE A SMALL PIECE OF NON SLIP MATERIAL UNDER THE LEGS WHICH WILL GIVE YOU THE FLEXIBILITY THE ADJUSTERS NEED.

When moving the bed it is essential that it is **LIFTED** into the new position. **NEVER DRAG** the bed as this will move the legs from the vertical position thus weakening the support of the centre rail.

Adhering to the recommended process should ensure that your bed gives you years of trouble free service.